

radura®

OEM QUALITY REPLACEMENT PARTS

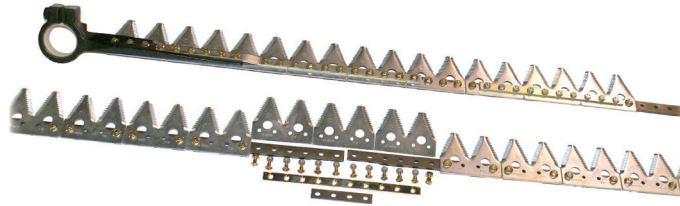

SECTIONALIZED REPLACEMENT KNIVES

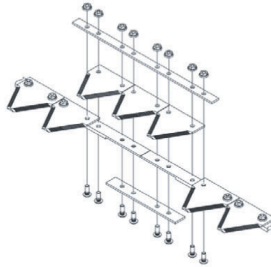
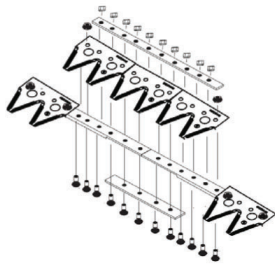
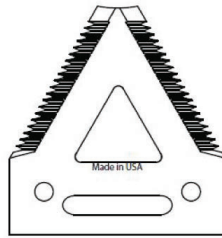
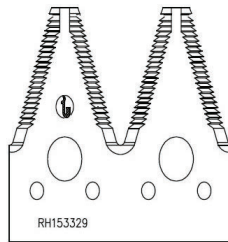

- UPS Shippable
- Hardware Included
- Easily Assembled

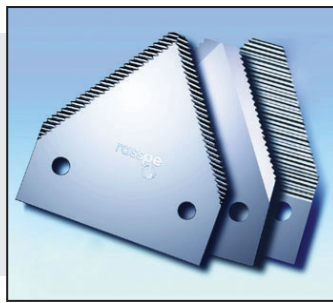

CALL US FOR PRICING

Visit us online at www.argis2000.ca



OEM REPLACEMENT KNIFE ASSEMBLIES

John Deere 600 Series 7-tpi Knives

Part No.	Description
80085.01	JD625
80086.01	JD630
80087.01	JD635

*Does not include knifehead

CIH 1010 & 1020 Series 9-tpi Knives

Part No.	Description
80159	CIH 1010/1020 - 17.5'
80160	CIH 1010/1020 - 20'
80162	CIH 1010/1020 - 25'
80163	CIH 1010/1020 - 30'

John Deere 900 Series 7-tpi Knives

Part No.	Description
80045	JD920
80046	JD922
80048	JD925
80049	JD930

Replacement Parts

02559.01	JD 600 Series Knifehead
52094	JD 900 Series Knifehead
51520.01	CIH1010/1020 Series Knifehead

COMING SOON

OEM replacement knife assemblies for MacDon Series

OEM REPLACEMENT GUARDS

Agco

Part No.	Models
42859.60	All Gleaner Combines

CIH

Radura Part No.	Models
42877.60	Combine - 1020

New Holland

Part No.	Models
50932.60	Headers 971, 973, 71C, 73C, 74C; All Mowers

MacDon

Part No.	Models
80640	Auger Headers 912, 922; Harvest Headers 962, 963, 972, 973, 974FD, D50, D60, D65, FD70, FD75; Mower Conditioners 5020, A30-S, A30-D; Windrower Headers A30-S, A30-D, A40-D

John Deere

Part No.	Models
42862.60	Combine – all models
42835.60	Combines – all 3-prong applications
53603.60	600F Series – LSL Blunt Pt.
53604.60	600F Series – SLS Blunt Pt.

OEM Replacement Sections

Part No.	Models & OEM #
80010.03	John Deere (7-tpi) (H153329)
80011.03	John Deere (14-tpi) (H163131)
80140.01	CIH (112074A1)
41830.60	MacDon (34390)

Call for Pricing

call: 519-291-4205 | email: info@argis2000.ca